

# Kodak

KC50/55  
Camera



This device complies with part 15 of the FCC Rules. Operation is subject to the following two conditions: (1) This device may not cause harmful interference, and (2) this device must accept any interference received, including interference that may cause undesired operation.

**NOTE:** Your model camera has been tested and found to comply with the limits for a Class B digital device, pursuant to Part 15 of the FCC Rules. These limits provide reasonable protection against interference in residential use. The camera generates, uses and can radiate radio frequency energy and, if not used in accordance with the instructions, may cause interference to radio communications. There is no guarantee that interference will not occur. If this camera does cause interference to radio or television reception, which can be determined by turning the camera off and on, you may reduce the interference by the following:

- Reorient or relocate the receiving antenna.
- Increase the separation between the camera and the receiver.
- Consult the dealer or an experienced radio/television technician for help.

Changes or modifications not approved by the party responsible for compliance could void the user's authority to operate the equipment.

**This Class B digital apparatus meets all requirements of the Canadian Interference-Causing Equipment Regulations.**

# Getting to Know Your Camera

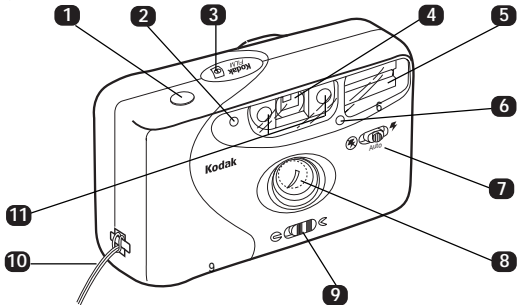

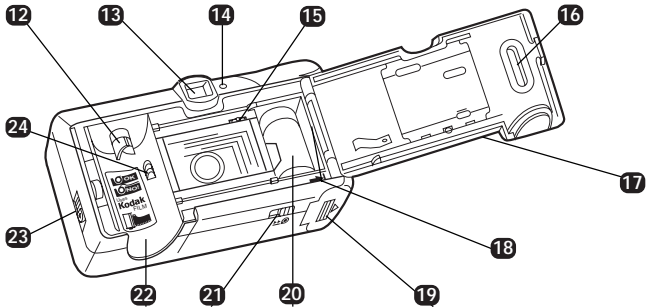

# Contents

|                                                |    |
|------------------------------------------------|----|
| Need Help with Your Camera? .....              | 6  |
| Camera Identification .....                    | 7  |
| Specifications .....                           | 8  |
| Loading the Batteries .....                    | 9  |
| Loading the Film .....                         | 10 |
| Taking a Picture .....                         | 14 |
| Taking Flash Pictures .....                    | 18 |
| Unloading the Film .....                       | 21 |
| Troubleshooting .....                          | 22 |
| For Owners of the Quartz Date Back Model ..... | 25 |

## Need Help with Your Camera?

Call:

Kodak (USA only) toll free from 9:00 a.m. to 7:00 p.m. (Eastern time) Monday through Friday at 1 (800) 242-2424.

Kodak (Canada only) from 8:30 a.m. to 5:00 p.m. (Eastern time) Monday through Friday at 1 (800) 465-6325, ext. 36100; for the Toronto area, call (416) 766-8233, ext. 36100.

Visit our web site at [www.kodak.com](http://www.kodak.com).

---

For warranty purposes, please keep your sales receipt as proof of the date of purchase.

© Eastman Kodak Company, 1997

## Camera Identification (see inside front cover for diagrams)

- |                                 |                                      |
|---------------------------------|--------------------------------------|
| <b>1</b> Shutter Button         | <b>13</b> Viewfinder Eyepiece        |
| <b>2</b> Flash Sensor           | <b>14</b> Flash- /Camera-Ready Light |
| <b>3</b> Picture Counter        | <b>15</b> Sprocket Teeth             |
| <b>4</b> Viewfinder             | <b>16</b> Film Window                |
| <b>5</b> Flash                  | <b>17</b> Film Door                  |
| <b>6</b> Red-Eye-Reduction Lamp | <b>18</b> Film-Load Mark             |
| <b>7</b> Flash Switch           | <b>19</b> Battery-Door Latch         |
| <b>8</b> Lens                   | <b>20</b> Take-Up Spool              |
| <b>9</b> Len-Cover Switch       | <b>21</b> Film-Rewind Switch         |
| <b>10</b> Camera Strap          | <b>22</b> Film Chamber               |
| <b>11</b> Auto-Focus Windows    | <b>23</b> Film-Door Latch            |
| <b>12</b> Film Spindle          | <b>24</b> DX-Code Sensors            |

# Specifications

|                            |                                                                                                            |
|----------------------------|------------------------------------------------------------------------------------------------------------|
| <b>Type:</b>               | Compact 35 mm auto-focus camera                                                                            |
| <b>Lens:</b>               | 29 mm, 3-element hybrid                                                                                    |
| <b>Viewfinder:</b>         | Reverse-Galilean                                                                                           |
| <b>Aperture:</b>           | <i>f</i> /5.6                                                                                              |
| <b>Focus Range:</b>        | Daylight: 4 ft. (1.2 m) to infinity                                                                        |
| <b>Flash Unit:</b>         | Electronic flash with ISO 100/21°, guide number of 7.5 m; flash automatically turns on at low-light levels |
| <b>Flash Recycle Time:</b> | Approximately 5 sec with fresh batteries                                                                   |
| <b>Power Source:</b>       | 2 AA-size alkaline batteries                                                                               |
| <b>Dimensions:</b>         | 4.7 x 2.6 x 1.7 in. (120.4 x 65.2 x 43.7 mm)                                                               |
| <b>Weight:</b>             | 6 oz. (170 g) without film and batteries                                                                   |

## Loading the Batteries

This camera uses 2 AA-size alkaline batteries.

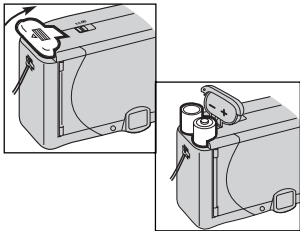

### Low-Battery Warning

It's time to replace the batteries when—

- the flash- /camera-ready light takes more than 30 seconds to turn on.
- the camera motor slows down or will not run.
- the film will not advance.

### Auto Power Off

This camera automatically turns off after approximately 2 minutes to conserve battery power if it is not used.

## Loading the Film

If in sunlight, turn your back to the sun and load the film in the shade of your body.

1. Slide the FILM-DOOR LATCH **23** down; then open the FILM DOOR **17**.

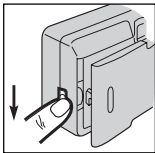

2. Insert the film into the FILM CHAMBER **22**. Place the flat, recessed end of the film over the FILM SPINDLE **12**. Push the other end of the film down into the film chamber until it snaps into place.

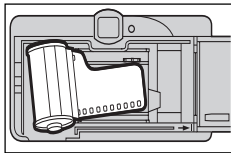

3. Pull out just enough film to place the end of the film at the **FILM-LOAD MARK** **18**.  
(Be sure the end of the film is at the film-load mark or you may not get any pictures).

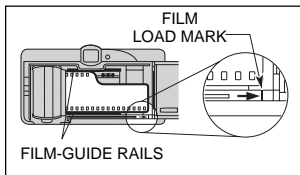

Lay the film flat between the film-guide rails.

If the end of the film extends past the film-load mark, gently push the excess back into the film cartridge.

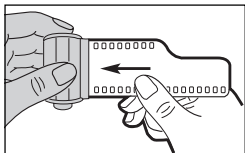

4. Snap the film door closed.  
You should be able to read the film information in the FILM WINDOW **16**.

**CAUTION:** Do not open the film door if you have film loaded in the camera.

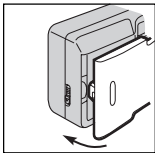

5. Slide the LENS-COVER SWITCH **9** to uncover the LENS **8** and turn the camera on.

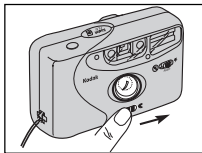

6. Press the SHUTTER BUTTON **1** three times so that the PICTURE COUNTER **3** moves to "1."

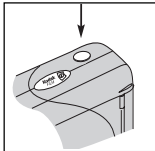

**NOTE:** Because of limited space on the picture counter, dots stand for frames 2 and 3. Beginning at frame 4, only even numbers show.

## Taking a Picture

1. Slide the LENS-COVER SWITCH **9** open until it locks into place. The camera will not work if the lens cover is not **completely** open.

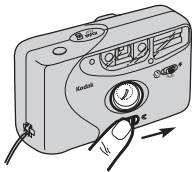

2. For a sharp picture, be at least 4 ft (1.2 m) from your subject in daylight and when using flash.

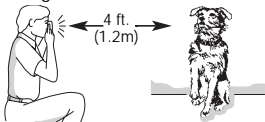

3. Look through the VIEWFINDER EYEPIECE **13** to see your subject.



4. Hold the camera steady and gently press the SHUTTER BUTTON **1** to take a picture. Wait for the FLASH-/CAMERA-READY LIGHT **14** to turn "on" before you take the picture. The flash automatically fires when you take a picture (see **TAKING FLASH PICTURES**). **Do not block the lens or flash with your fingers, strap, or any other object.**

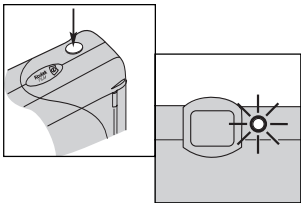

5. The film automatically advances so you can take your next picture.

### *Using the Focus Lock*

This camera automatically focuses on whatever is within the auto-focus frame of the viewfinder eyepiece. If you want to take a picture with the subject positioned outside of the auto-focus frame, use the focus lock as follow:

1. Place the auto-focus frame on the subject that you want focused in the picture.

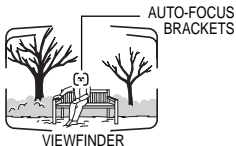

2. Partially depress and hold the SHUTTER BUTTON **1** to lock the focus position.

3. While still partially depressing the shutter button move the camera until your subject is where you want it.

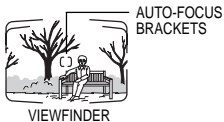

4. Press the shutter button completely down to take the picture.

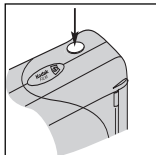

## Taking Flash Pictures

In dim light, such as indoors or outdoors in heavy shade, or on dark overcast days, you need flash. Your camera features an automatic flash that fires when you need it.

1. Slide the LENS-COVER SWITCH **9** open to turn the camera on.
2. When the FLASH- /CAMERA-READY LIGHT **14** turns "on", you are ready to take the picture.
3. Keep the subject within the distance range for the speed

| ISO Film Speed | Flash-to-Subject Distance |
|----------------|---------------------------|
| 100            | 4 to 9 ft (1.2 to 2.8 m)  |
| 200            | 4 to 13 ft (1.2 to 4.0 m) |
| 400            | 4 to 18 ft (1.2 to 5.5 m) |

of the film in your camera.  
**Do not block the flash or lens with your fingers, strap, or any other object.**

Using Fill Flash and Flash Off  
*Fill Flash*—Bright light indoors or outdoors from backlit subjects can create dark shadows (especially on faces) in contrasty scenes. Use fill flash to lighten the shadows.  
*Flash Off*—When you do not want to use the flash, especially

indoors, or in dim lighting situations, use flash off.

1. Slide the LENS-COVER SWITCH **9** open.
2. Push the FLASH SWITCH **7** to either the fill flash or flash off mode and **hold into position without lifting your finger.**

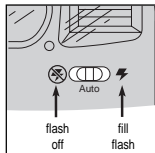

3. While still pressing the desired flash mode, press the SHUTTER BUTTON **1** to take a picture.

### Using Red-Eye-Reduction

To minimize red-eye in flash pictures of people, use the red-eye-reduction feature.

Whenever the flash is needed, the red-eye-reduction will automatically be active.

1. Partially depress the SHUTTER BUTTON **1**. The RED-EYE-

REDUCTION LAMP **6** stays on as long as the shutter button is partially depressed.

2. Have your subject look directly at the red-eye-reduction lamp for a **few seconds** before you take the picture.
3. If you choose not to use red-eye-reduction, **do not delay** in pressing the shutter button.

## Unloading the Film

After you take the last picture on the roll of film, slide the **FILM-REWIND SWITCH** **21** into position to start the film rewind. You may get a few extra pictures on a roll (26 instead of 24, etc.). Wait for the camera motor to stop before you open the **FILM DOOR** **17** and remove the film cartridge.

## Using Mid-Roll Rewind

If you don't want to take pictures on the entire roll of film, you can rewind the film manually. Slide the **FILM-REWIND SWITCH** **21** in until it latches and remains in the on position. Wait for the camera motor to stop before you remove the film cartridge.

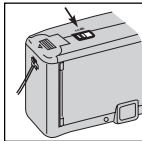

# Troubleshooting

| What happened           | Probable cause                                        | Solution                                                          |
|-------------------------|-------------------------------------------------------|-------------------------------------------------------------------|
| Camera will not operate | Lens cover closed                                     | Slide the lens-cover switch to uncover lens and turn on camera    |
|                         | Batteries weak, dead, missing, or improperly inserted | Replace or reload the batteries; see <b>Loading the Batteries</b> |

| What happened                  | Probable cause                                        | Solution                                                            |
|--------------------------------|-------------------------------------------------------|---------------------------------------------------------------------|
| Picture counter returns to "S" | Film door opened                                      | Close film door and rewind film to avoid losing additional pictures |
| Film does not advance          | Batteries weak, dead, missing, or improperly inserted | Replace or reload the batteries; see <b>Loading the Batteries</b>   |
|                                | Film not loaded properly                              | See <b>Loading the Film</b>                                         |

| What happened                                                 | Probable cause                                        | Solution                                                          |
|---------------------------------------------------------------|-------------------------------------------------------|-------------------------------------------------------------------|
| Film does not rewind                                          | Film did not load properly                            | See <b>Loading the Film</b>                                       |
|                                                               | Batteries weak, dead, missing, or improperly inserted | Replace or reload the batteries; see <b>Loading the Batteries</b> |
| Flash- /camera-ready light fails to turn on within 30 seconds | Batteries weak                                        | Replace with fresh AA-size alkaline batteries                     |

## For Owners of the Quartz Date Back Model

### Setting the Date and Time

The date and time feature enables you to record the date in a choice of four formats: (month/day/year, day/month/year, year/month/day) or time (day/hour/minute) directly onto the film.

### Date and Time Imprinting

Press the Mode Button **(b)** to select the desired data type; then take the picture. Following the exposure, the Print Indicator **(a)** blinks in the data panel for approximately two-to-three seconds to confirm imprinting.



## Mode Selection

Use the Mode Button **(b)** to change the data display as shown.

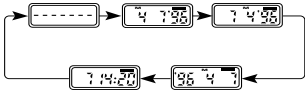

## Setting Data

1. Press the Mode Button **(b)** to select the desired data type.

2. Use the Select Button **(c)** to move between different parts of the displayed data. With the data displayed, pressing the select button in succession causes the settings for year, month, and then day to blink. On the data panel, the letter "M" indicates the location for the month and the apostrophe " ' " for the year.

In time mode, pressing the select button successively causes the hour, minute, and then the colon to blink.

3. Press the Set Button **(d)** to change the blinking display.

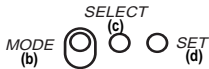
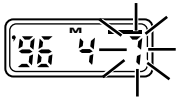

### Replacing the Date Back Battery

1. Open the film door. Remove the screw from the battery cover using a small screw driver.

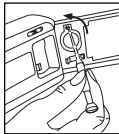

2. Remove the battery cover and insert a new 3-volt lithium CR 2025 (+ side up) battery.

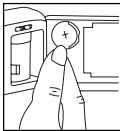

3. Replace the battery cover and reattach the screw. Reset the date and time.

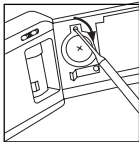

**Date back subject to minor appearance and specification changes.**

Kodak is a trademark.



Consumer Imaging  
**EASTMAN KODAK COMPANY**  
Rochester, NY 14650

Pt. No. 916 5101

1-97  
Printed in USA